



CE EAC  
No. 08190322KTN.UU45

**KTN**  
Kara Technology News®

VÁLVULA DE MARIPOSA WAFER ASIENTO EPDM  
DN 40 - 500 | PN16/10  
Agua, Agua de Mar, Vapor, Ácidos diluidos, Petróleo

WAFER BUTTERFLY VALVE EPDM SEAT  
DN 40 - 500 | PN16/10  
Water, Seawater, Steam, Diluted acids, Oil & gas



# FIG 2661E

VÁLVULA DE MARIPOSA WAFER ASIENTO EPDM PN10/PN16, DN40-300  
 WAFER BUTTERFLY VALVE WITH EPDM SEAT PN10/PN16, DN40-300

## TOP FLANGE

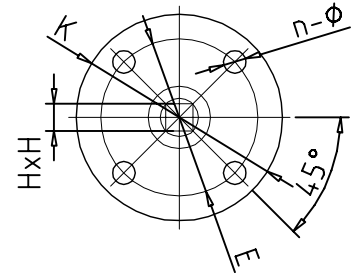

DISEÑO / DESIGN	EN593
CARA A CARA / FACE TO FACE	EN558-1
NORMA BRIDAS / FLANGED ENDS	EN1092-2PN10/16
TEST	EN12266-1
MAX. TEMP	-20 + 120°C
PRESIÓN / PRESSURE	PN 10/16
ESTANQUEIDAD / TIGHTNESS	Asiento / Seal PN x 1.1
	Cuerpo / Body x 1.5
MEDIO / MEDIUM	Ácidos, alcalinos, sales, petróleo / Acid, Alkali, Salt, Oil & gas

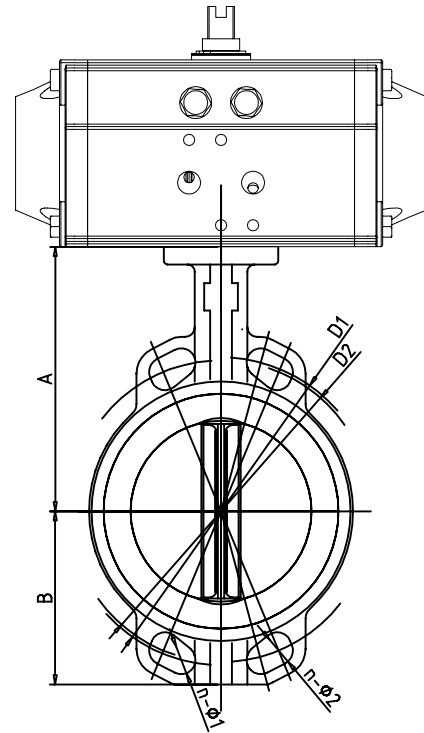
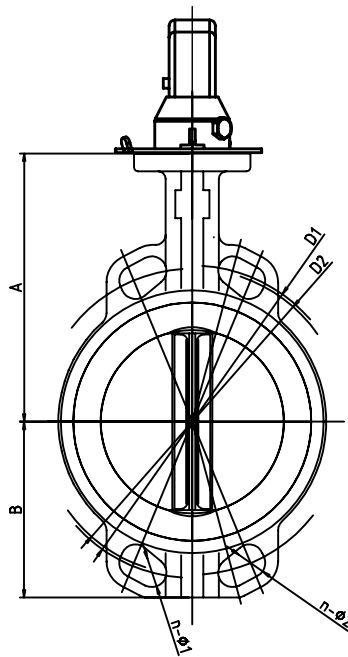
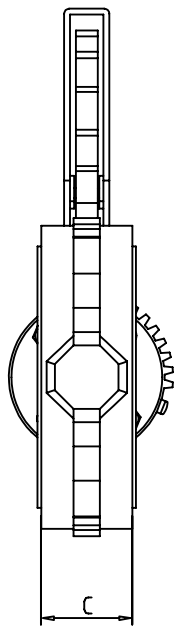

DN	A	B	C	Ø 2	K	E	N-Ø	PN10/16		JIS10K		HxH	ISO 5211	PAR DE APRIETE OPENING TORQUE (PN10/16)	PESO WEIGHT (Kg)
								D1	N-Ø1	D2	N-Ø2				
40	120	65	33	12.6	65	50	4-7	110	4-19	105	4-19	9x9	F05	11	2.07
50	140	80	43	12.6	90	70	4-7	125	4-19	120	4-19	9x9	F05	12	2.51
65	150	89	46	12.6	90	70	4-7	145	4-19	140	4-19	9x9	F05	20	3.1
80	158	95	46	12.6	90	70	4-7	160	8-19	150	8-19	9x9	F05	30	3.14
100	176	114	52	15.77	90	70	4-10	180	8-19	175	8-19	11X11	F07	50	4.8
125	190	127	56	18.92	90	70	4-10	210	8-19	210	8-23	14X14	F07	77	6.73
150	212	139	56	18.92	90	70	4-10	240	8-23	240	8-23	14X14	F07	121	7.41
200	236	174	60	22.10	125	102	4-12	295	8/12-23	290	12-23	17X17	F10	242	13.6

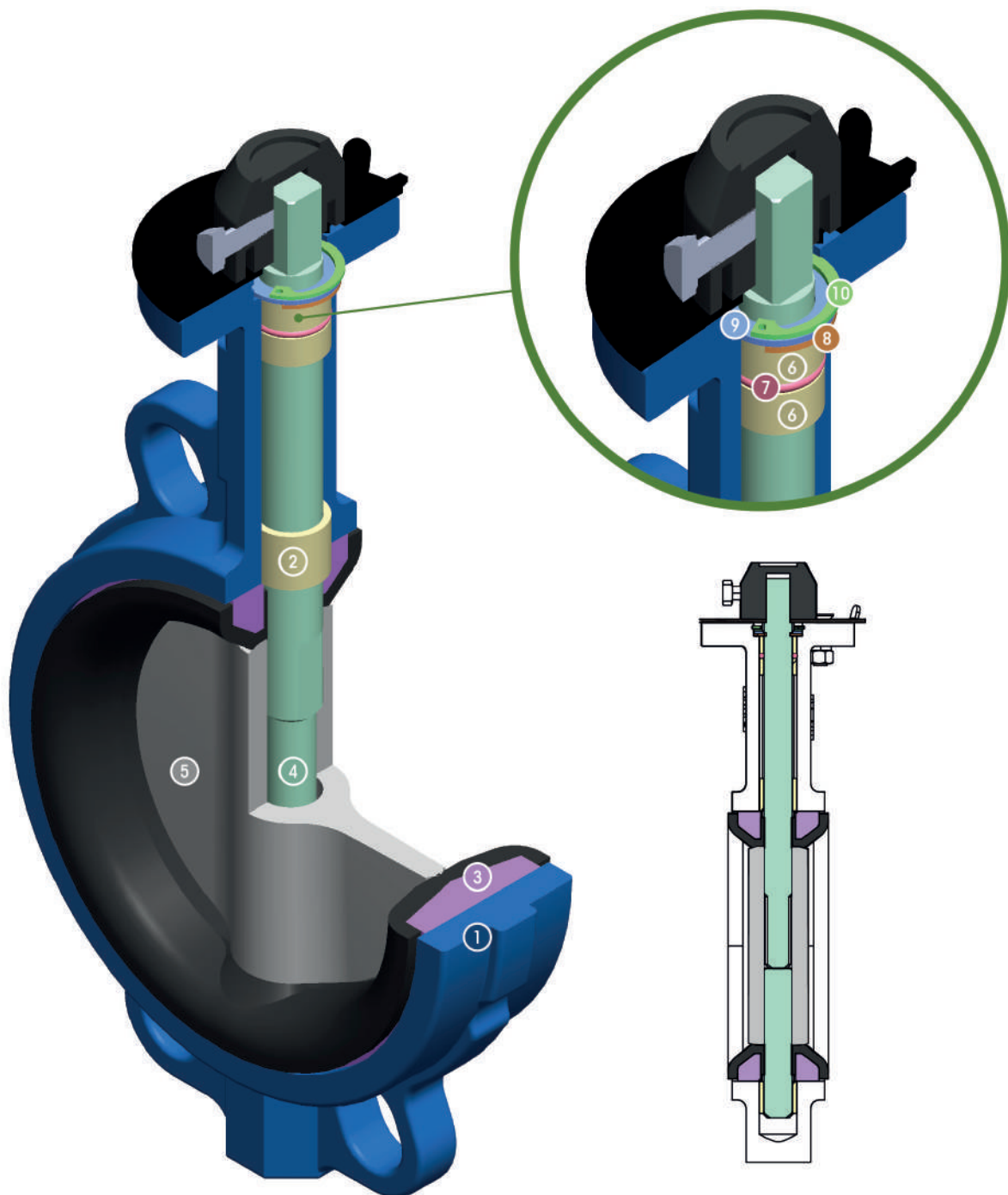

Nº	PIEZA / DESIGNATION	MATERIAL	PZ/QTY	Nº	PIEZA / DESIGNATION	MATERIAL	PZ/QTY
1	Cuerpo / Body	EN1561 EN-GJL-200	1	6	Estopada / Short bushing	FRP	2
2	Casquillo Guía / Long Bushing	FRP	2	7	Junta Tórica / O-Ring	NBR	1
3	Pistón (asiento) / Liner (Seat)	WRAS EPDM	1	8	Casquillo / Half ring	SS	1
4	Eje / Shaft	SS410	2	9	Junta / Gasket	SS	1
5	Disc	CF8M	1	10	Resorte superior / Snap Ring	SK7	1

**FIG 266IE**
**VÁLVULA DE MARIPOSA WAFER ASIENTO EPDM CON VOLANTE REDUCTOR PN10/PN16, DN250**  
**REDUCTOR GEAR BOX WAFER BUTTERFLY VALVE WITH EPDM SEAT PN10/PN16, DN250**

DISEÑO / DESIGN	EN593
CARA A CARA / FACE TO FACE	EN558-1
NORMA BRIDAS / FLANGED ENDS	EN1092-2PN10/16
TEST	EN12266-1
MAX. TEMP	-20 + 120°C
PRESIÓN / PRESSURE	PN 10/16
ESTANQUEIDAD / TIGHTNESS	Asiento / Seal PN x 1.1
	Cuerpo / Body x 1.5
MEDIO / MEDIUM	Ácidos, alcalinos, sales, petróleo / Acid, Alkali, Salt, Oil & gas

10	Resorte a presión	Snap spring	SK7
9	Junta	Gasket	Stainless steel
8	Medio anillo	Half ring	Stainless steel
7	Junta tórica	O-Ring	NBR
6	Cojinete superior	Up Bushing	FRP
5	Disco	Disc	CF8M
4	Vástago	Shaft	SS410
3	Asiento	Line (Seat)	WRAS EPDM
2	Cojinete	Long bushing	FRP
1	Cuerpo	Body	EN1561 EN-GJL-200

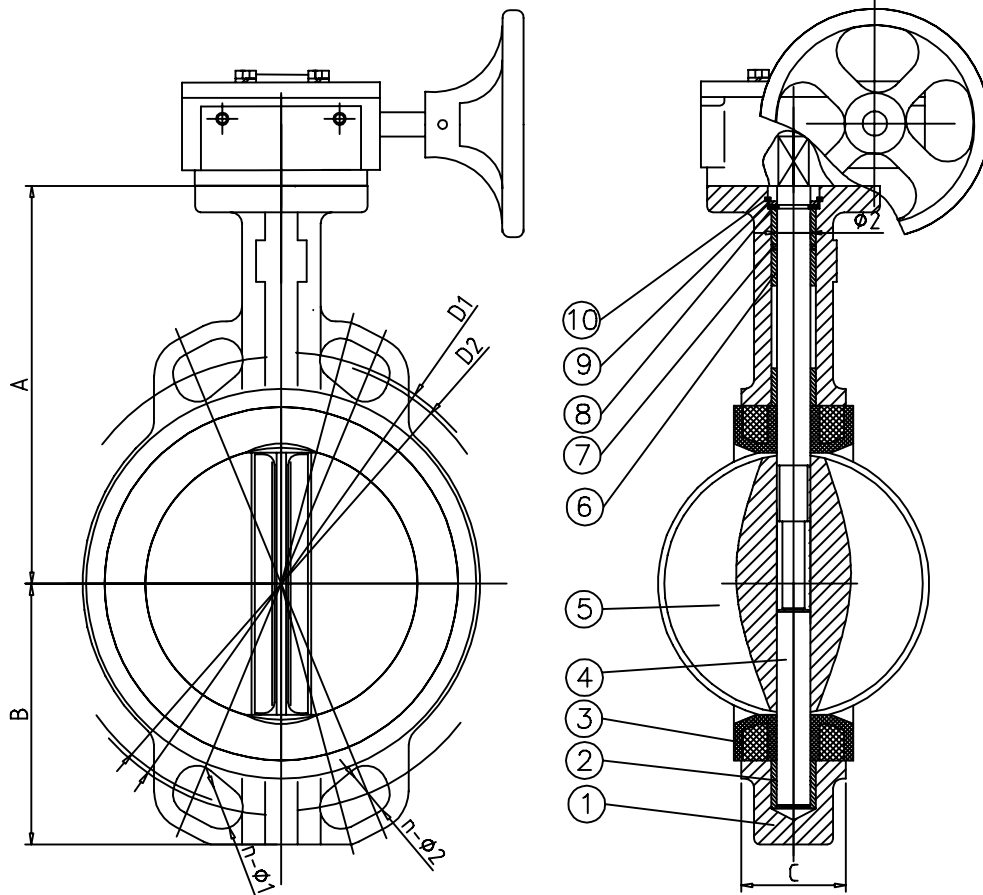

DN	A	B	C	Ø 2	K	E	N-Ø	PN10/16		JIS10K		HxH	ISO 5211	PAR DE APRIETE OPENING TORQUE (PN10/16)	PESO WEIGHT (Kg)
								D1	N-Ø1	D2	N-Ø2				
250	265	203	68	28.45	125	102	4-12	350/355	12-23/28	355	12-25	22x22	F10	-	-

**FIG 266IE**
**VÁLVULA DE MARIPOSA WAFER ASIENTO EPDM CON VOLANTE REDUCTOR PN10/PN16, DN300**  
**REDUCTOR GEAR BOX WAFER BUTTERFLY VALVE WITH EPDM SEAT PN10/PN16, DN300**

DISEÑO / DESIGN	EN593
CARA A CARA / FACE TO FACE	EN558-1
NORMA BRIDAS / FLANGED ENDS	EN1092-2PN10/16
TEST	EN12266-1
MAX. TEMP	-20 + 120°C
PRESIÓN / PRESSURE	PN 10/16
ESTANQUEIDAD / TIGHTNESS	Asiento / Seal PN x 1.1
	Cuerpo / Body x 1.5
MEDIO / MEDIUM	Ácidos, alcalinos, sales, petróleo / Acid, Alkali, Salt, Oil & gas

10	Resorte a presión	Snap spring	SK7
9	Junta	Gasket	Stainlesss steel
8	Medio anillo	Half ring	Stainlesss steel
7	Junta tórica	O-Ring	NBR
6	Cojinete superior	Up Bushing	FRP
5	Disco	Disc	CF8M
4	Vástago	Shaft	SS410
3	Asiento	Line (Seat)	WRAS EPDM
2	Cojinete	Long bushing	FRP
1	Cuerpo	Body	EN1561 EN-GJL-200

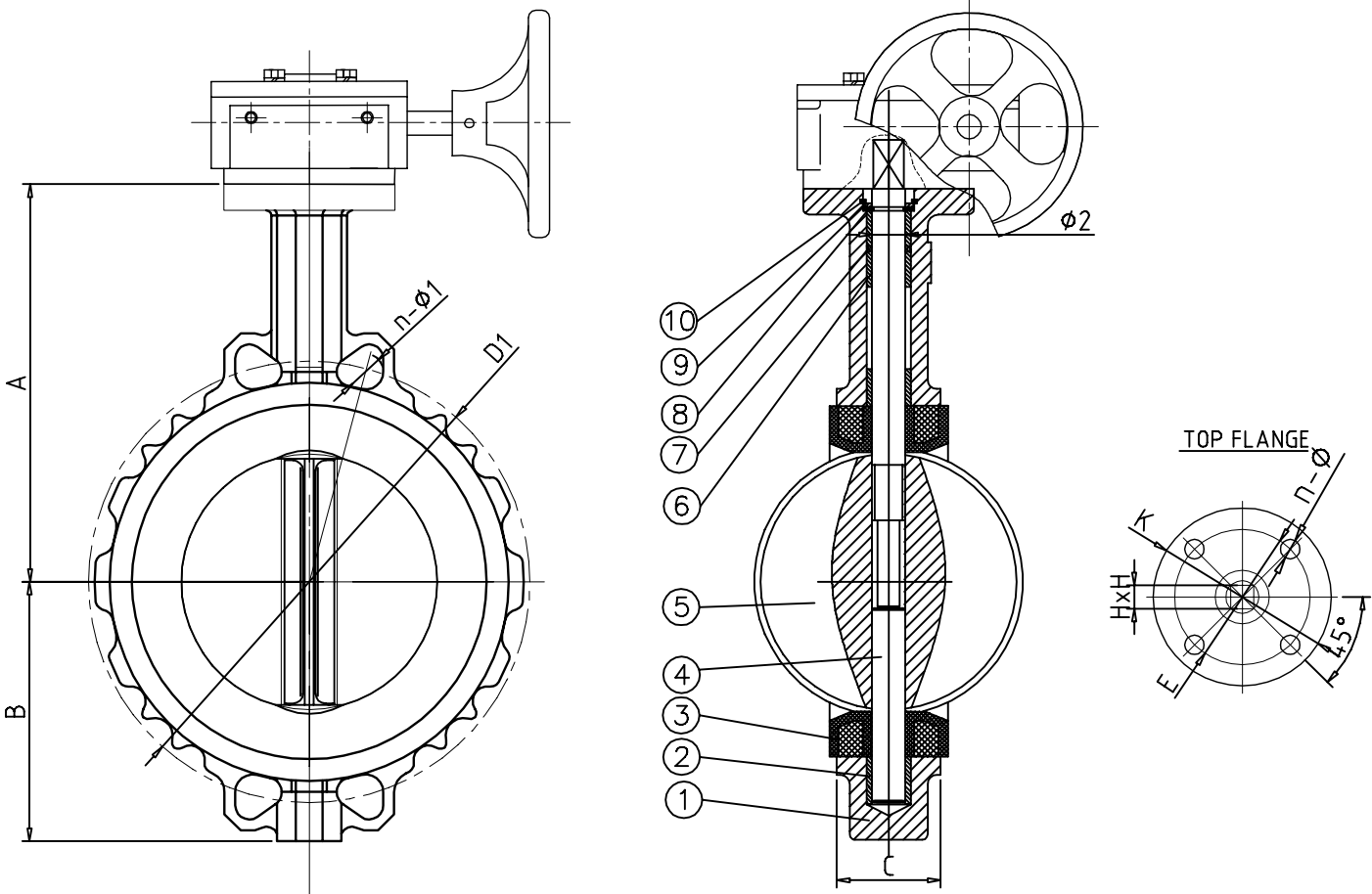

DN	A	B	C	Ø2	K	E	N-Ø	PN10/16		150 LB		HxH	ISO 5211	PAR DE APRIETE OPENING TORQUE (PN10/16)	PESO WEIGHT (Kg)
								D1	N-Ø1	D1	N-Ø1				
300	305	242	78	31.60	125	102	4-12	400/410	12-23/28	431.8	12-26	22x22	F10	-	-

**FIG  
266IE**
**VÁLVULA DE MARIPOSA WAFER ASIENTO EPDM CON VOLANTE REDUCTOR PN10/PN16, DN350**  
**REDUCTOR GEAR BOX WAFER BUTTERFLY VALVE WITH EPDM SEAT PN10/PN16, DN350**

DISEÑO / DESIGN	EN593
CARA A CARA / FACE TO FACE	EN558-1
NORMA BRIDAS / FLANGED ENDS	EN1092-2PN10/16
TEST	EN12266-1
MAX. TEMP	-20 + 120°C
PRESIÓN / PRESSURE	PN 10/16
ESTANQUEIDAD / TIGHTNESS	Asiento / Seal PN x 1.1
	Cuerpo / Body x 1.5
MEDIO / MEDIUM	Ácidos, alcalinos, sales, petróleo / Acid, Alkali, Salt, Oil & gas

11	Resorte a presión	Snap spring	SK7
10	Junta	Gasket	Stainless steel
9	Medio anillo	Half ring	Stainless steel
8	Cojinete	Short bushing	FRP
7	Junta tórica	O-Ring	NBR
6	Cojinete superior	Up Bushing	FRP
5	Disco	Disc	CF8M
4	Vástago	Shaft	SS410
3	Asiento	Line (Seat)	WRAS EPDM
2	Cojinete	Long bushing	FRP
1	Cuerpo	Body	EN1561 EN-GJL-200

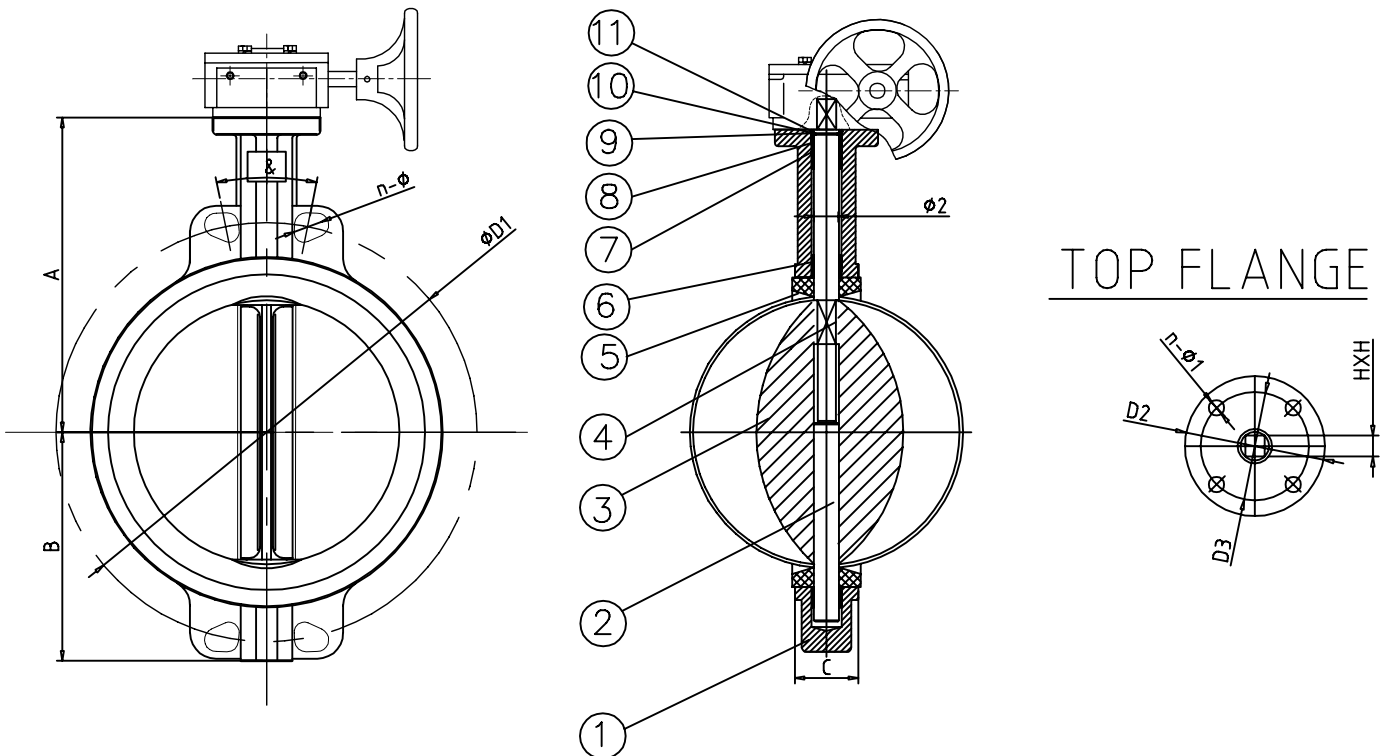

DN	A	B	C	Ø 2	D2	D3	N-Ø1	PN10			PN10/16			150LB			HxH	ISO 5211
								D1	N-Ø	&	D1	N-Ø	&	D1	N-Ø	&		
350	368	267	78	31.60	125	102	4-12	460	16-23	22.5	470	16-28	22.5	476.3	12-29	30	22x22	F10

**FIG  
266IE**
**VÁLVULA DE MARIPOSA WAFER ASIENTO EPDM CON VOLANTE REDUCTOR PN10/PN16, DN400-500**  
**REDUCTOR GEAR BOX WAFER BUTTERFLY VALVE WITH EPDM SEAT PN10/PN16, DN400-500**

DISEÑO / DESIGN	EN593
CARA A CARA / FACE TO FACE	EN558-1
NORMA BRIDAS / FLANGED ENDS	EN1092-2PN10/16
TEST	EN12266-1
MAX. TEMP	-20 + 120°C
PRESIÓN / PRESSURE	PN 10/16
ESTANQUEIDAD / TIGHTNESS	Asiento / Seal PN x 1.1
	Cuerpo / Body x 1.5
MEDIO / MEDIUM	Ácidos, alcalinos, sales, petróleo / Acid, Alkali, Salt, Oil & gas

10	Medio anillo	Half ring	Stainless steel
9	Cojinete	Gasket	Brass
8	Junta tórica	O-Ring	NBR
7	Cojinete	Long bushing	Brass
6	Asiento	Line (Seat)	WRAS EPDM
5	Vástago superior	Up shaft	SS410
4	Disco	Disc	CF8M
3	Vástago inferior	Down shaft	SS410
2	Cuerpo	Body	EN1561 EN-GJL-200
1	Tapa	End cover	EN1561 EN-GJL-200

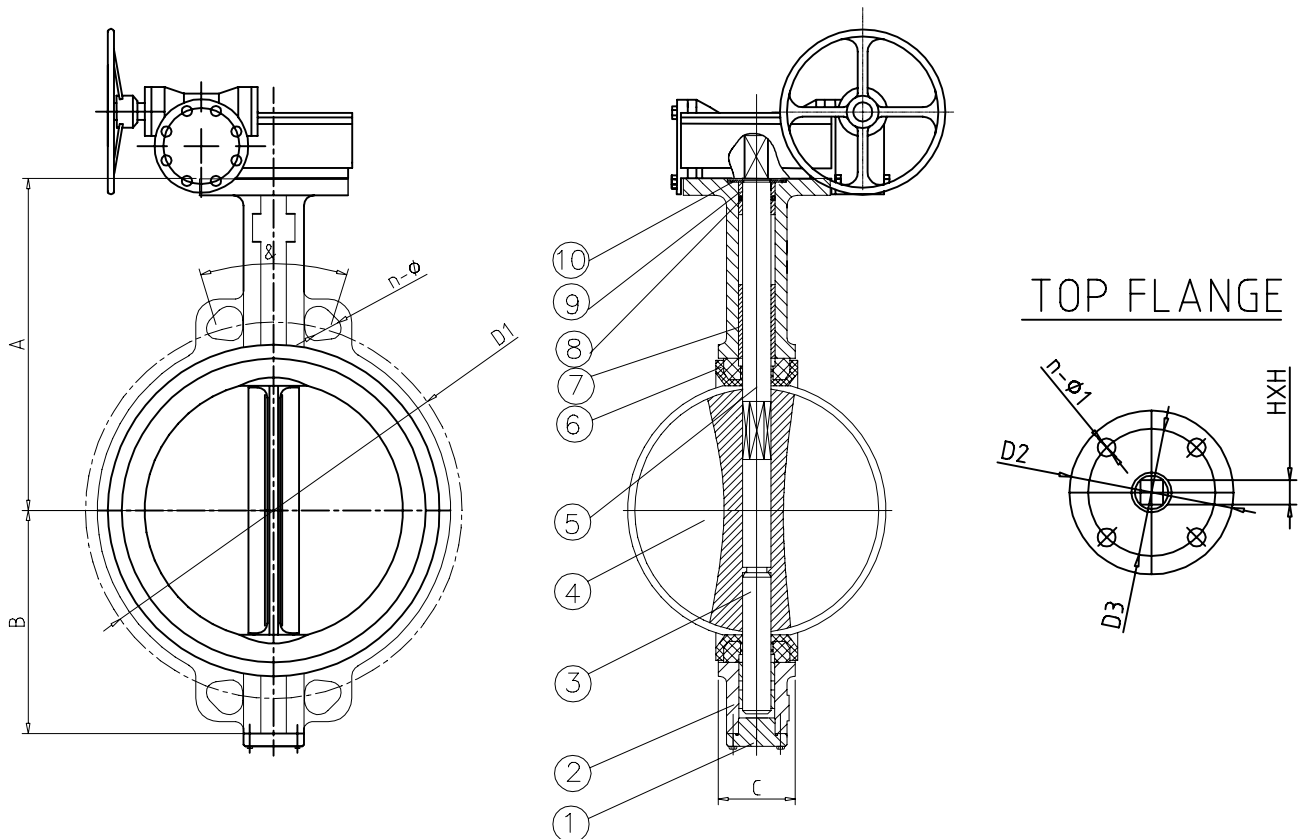

DN	A	B	C	D2	D3	N-Ø1	PN10			PN10/16			150LB			HxH	ISO 5211
							D1	N-Ø	&	D1	N-Ø	&	D1	N-Ø	&		
400	400	309	102	175	140	4-18	539.8	16-29	22.5	515	16-28	22.5	525	16-31	22.5	27x27	F14
450	422	340	114	175	140	4-18	577.9	16-32	22.5	565	20-28	18	585	20-31	18	27x27	
500	440	362	127	175	140	4-18	635	20-32	18	620	20-28	18	650	20-34	18	36x36	