

VÁLVULA DE RETENCIÓN CON EXTREMOS SOLDABLES

Cuerpo de acero inoxidable forjado, clase 800

CHECK VALVE WITH WELDABLE ENDS

Forged stainless steel body, class 800

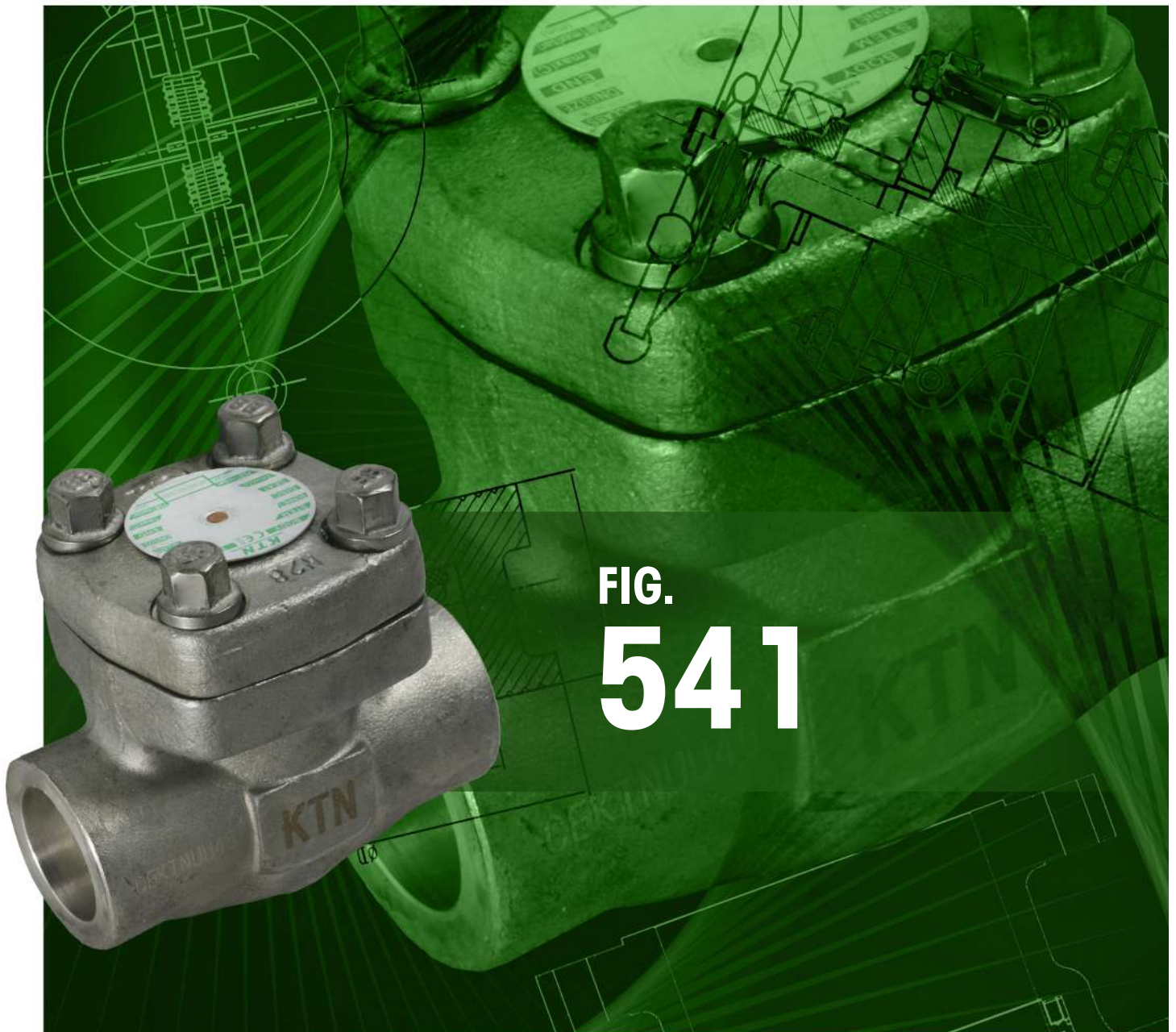
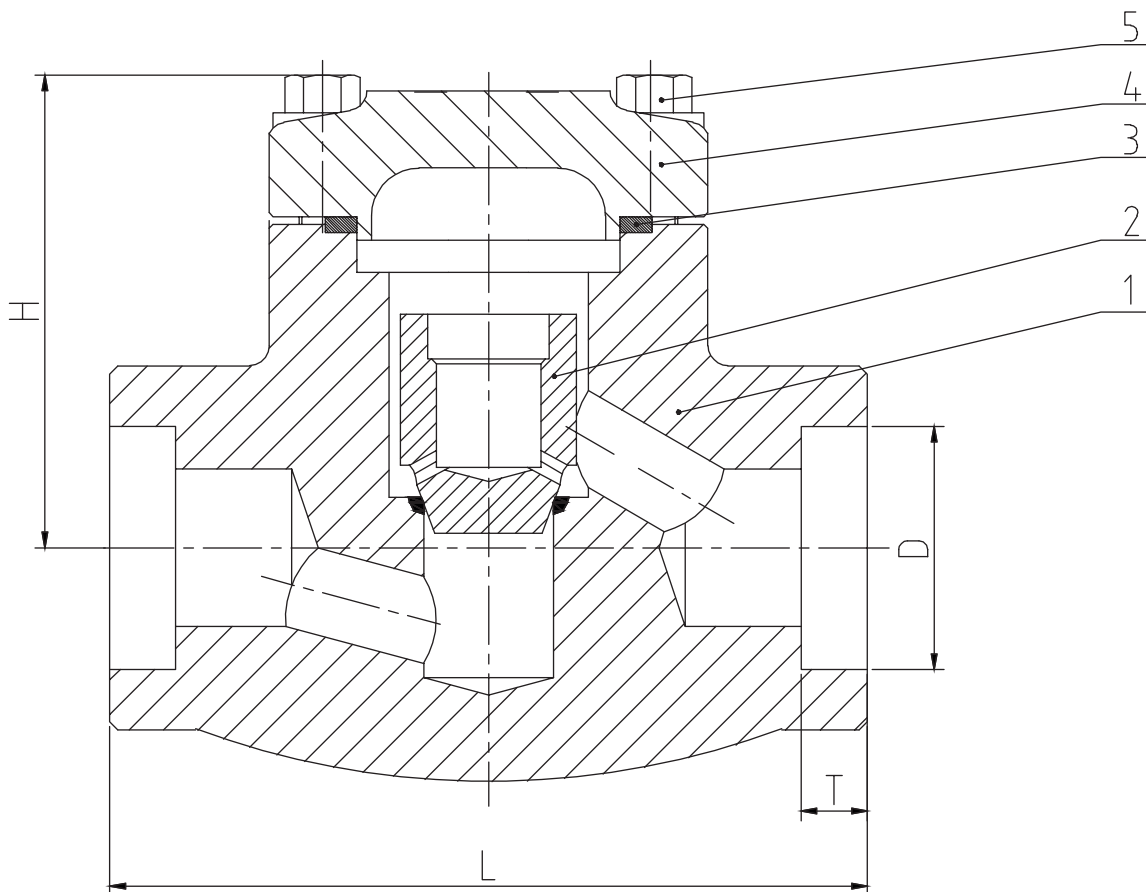

FIG.
541

DISEÑO / DESIGN	API 602
CARA A CARA / FACE TO FACE	ANSI B16.10
DIMENSIONES EXTREMOS SOLDABLES WELDABLE ENDS DIMENSIONS	ANSI B16.11
TEST	API598
MAX. TEMP	-29 + 425°C
MEDIO / MEDIUM	Agua, vapor aceite / Water, steam, oil

DN	"	L	H	D	T	PESO / WEIGHT (Kg)
15	1/2	79	61	21.8	9.6	1.1
20	3/4	92	61	27.1	12.7	1.2
25	1	111	78	33.8	12.7	2.3
40	1 1/2	152	84	48.7	12.7	5.5
50	2	172	118	61.2	15.9	7.5



3	Junta / Gasket	316+Graphite			
2	Disco / Disco	316L	5	Tornillo / Bolt	B8M
1	Cuerpo / Body	F316L	4	Bonete / Bonnet	F316L
Nº	PIEZA / DESIGNATION	MATERIAL	Nº	PIEZA / DESIGNATION	MATERIAL